

PARTS LIST

**CHICAGO
FAUCETS**

a GEBERIT company

540-LDGN8AE3-372SSCPR 540-LDGN8AE3-374SSCPR AS SHOWN WITH 374 BRASS HANDLES

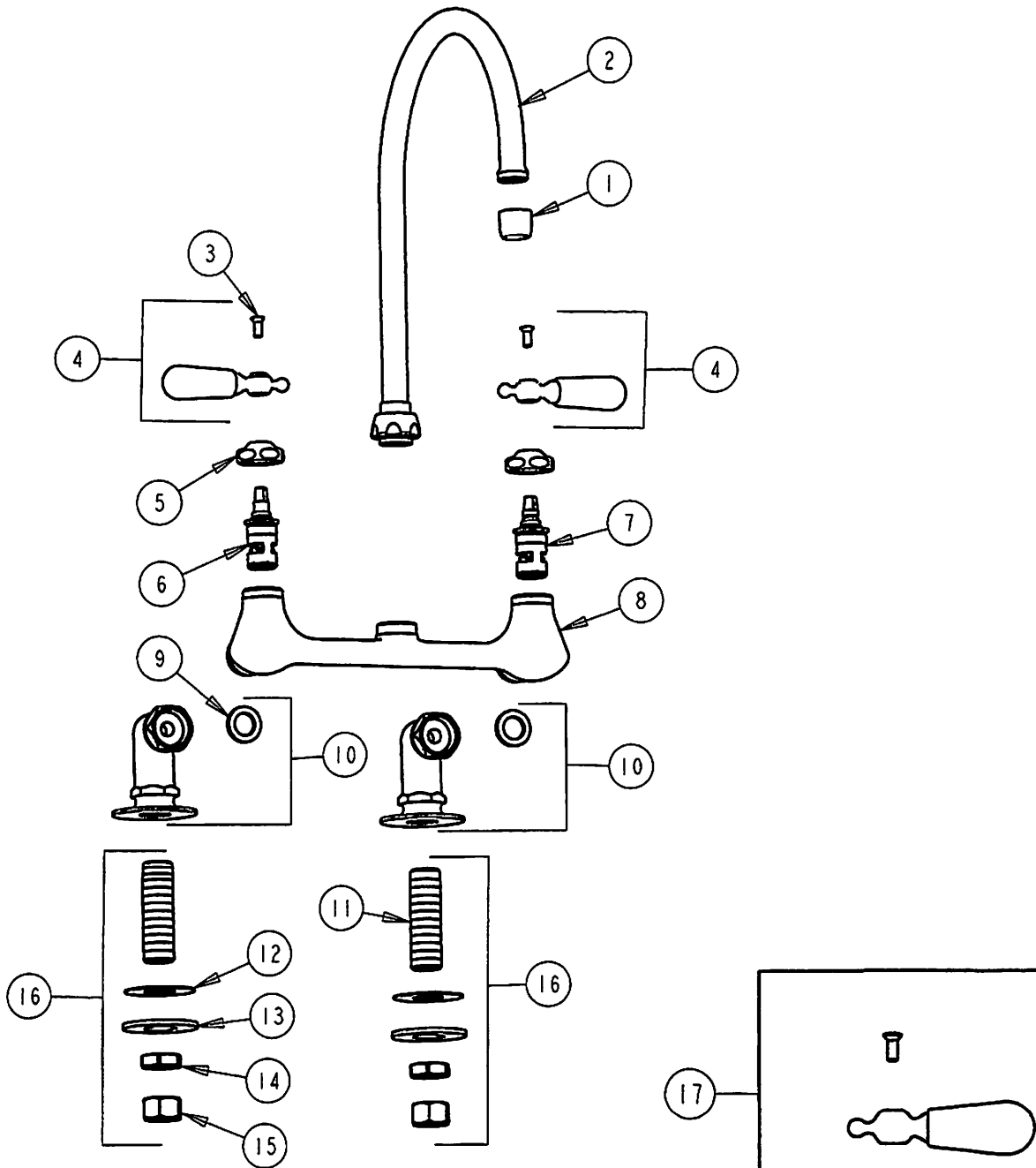

ITEM NO.	PART NO.	DESCRIPTION	ITEM NO.	PART NO.	DESCRIPTION
1	E3	SOFTFLO OUTLET	10	SS	ANGLE SHANK ASSEMBLY
2	GN8A	FOR PARTS SEE GN8A	11	748-002	SHANK
3	420-010	SCREW	12	52-007	RUBBER WASHER
4	372HPR	PORCELAIN HANDLE ASSEMBLY	13	807-002	GALVANIZED WASHER
5	1-214	CAP	14	49-004	LOCKNUT
6	1-100XK	LH CERAMIC QUATURN UNIT	15	49-005	COUPLING NUT
7	1-099XK	RH CERAMIC QUATURN UNIT	16	748-002K	MALE SHANK ASSEMBLY
8	-----	VALVE BODY (NOT SOLD SEPARATELY)	17	374-PLPR	BRASS HANDLE ASSEMBLY
9	1-011	WASHER			

CHICAGO FAUCETS

a **GEBERIT** company

2100 SOUTH CLEARWATER DRIVE
DES PLAINES, ILLINOIS 60018-5999
847-803-5000

FITTING NO.

540-LDGN8AE3-374SS

SUBMITTED MODEL NO.

JOB NAME

ITEM NO.

SUBMITTED AS SHOWN

SUBMITTED AS NOTED

SEE ATTACHED FOR
SUBMITTED MODIFICATION



ADA COMPLIANT

Roughing in dimensions may vary and are subject to change. No responsibility is assumed for use of superseded or voided data.

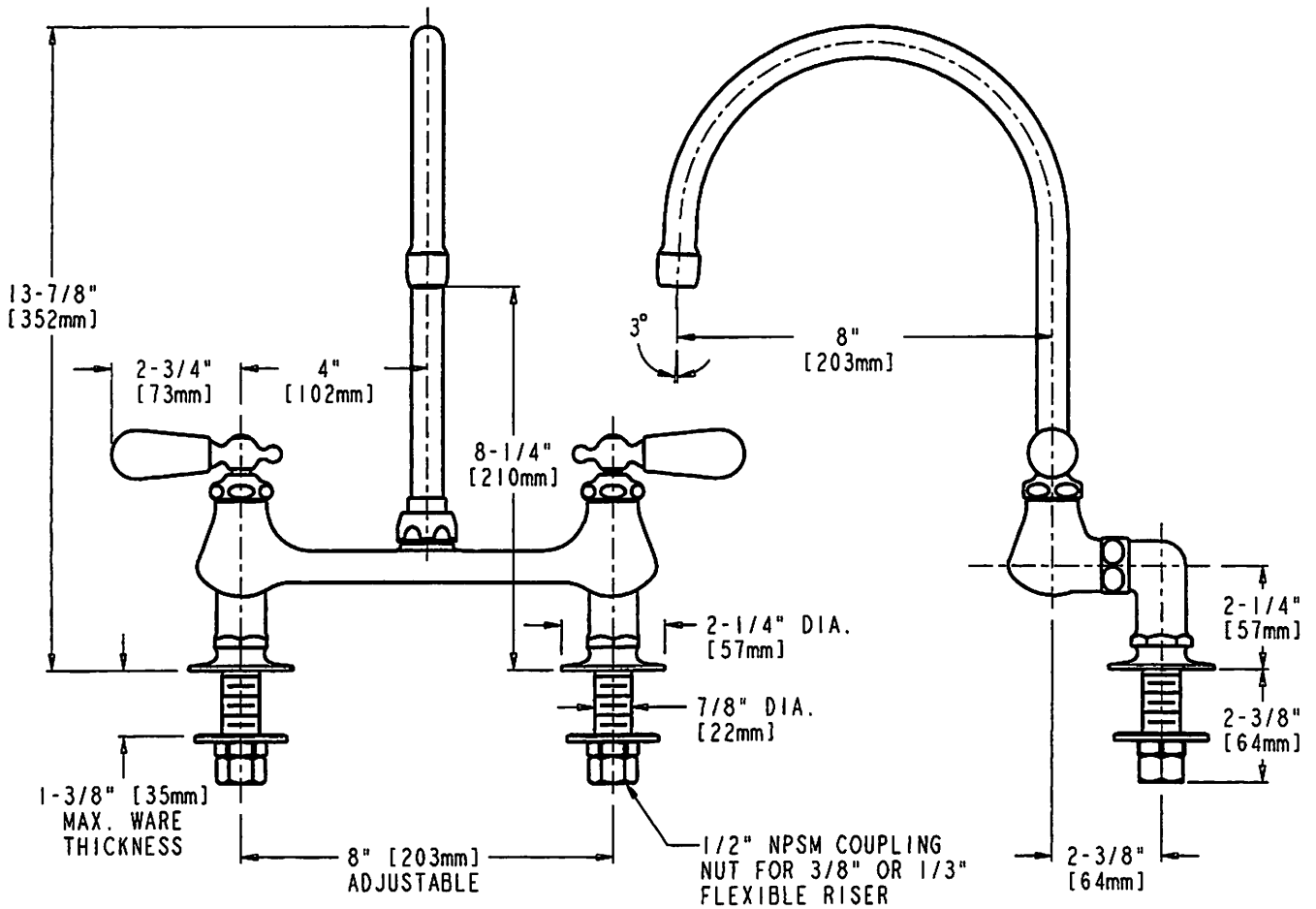

DIMENSIONS IN INCHES AND [MILLIMETERS]

TECHNICAL DATA

SPECIFICATION MANUAL

- RESIDENTIAL DECK MOUNTED FITTING
- GN8A RIGID/SWING GOOSENECK SPOUT
- 374 METAL LEVER HANDLES
- CERAMIC DISC CARTRIDGES
- 'SS' SHORT ANGLE INLET ARMS
- FINISH: CHROME

- MALE THREAD SHANK ASSEMBLY
- E3 SOFTFLO AERATOR
- 2.2 GPM (8.3 L/min.) FLOW RATE
- ASME A112.18 IM COMPLIANT
- CSA B125 COMPLIANT
- NSF 61, SECTION 9